

**Motor GM15-N20VA-08220-100-10D** Art.-Nr.: 860513

**Specification :**

| Item                               | Unit            | Specification              |
|------------------------------------|-----------------|----------------------------|
| Rated voltage                      | V <sub>DC</sub> | 6.0                        |
| Gear Ratio                         |                 | 1/100                      |
| Rotation                           |                 | CW                         |
| Motor Position                     |                 | All position in horizontal |
| Temperature                        | °C              | 0~30                       |
| Humidity                           | %               | 30~95                      |
| <b>• Performance of Motor</b>      |                 |                            |
| No-load Speed                      | rpm             | 16.500±10%                 |
| No-load Current                    | mA              | 35 (max.)                  |
| Stall Current                      | mA              | 650 (max.)                 |
| Stall Torque                       | g.cm            | 10                         |
| <b>• Performance of Gear motor</b> |                 |                            |
| Output Speed                       | rpm             | 160±10%                    |
| No-load Current                    | mA              | 40 (max.)                  |
| Stall Current                      | mA              | 650 (max.)                 |
| Stall Torque                       | kg.cm           | 1.5                        |
| Rated Torque                       | g.cm            | 400                        |
| Rated Current                      | mA              | 150 (max.)                 |
| Noise                              | dB              | 48                         |
| <b>• The Dimension</b>             |                 |                            |
| The Outside Shaft Length           | mm              | 9.0                        |
| Shaft End Play                     | mm              | 0.05-0.30                  |
| Screw Size                         |                 | M1.6*0.35                  |
| Dia of Shaft                       | mm              | Ø3.0*2.5mm                 |

**Motor GM15-N20VA-08220-100-10D**

Art.-Nr.: 860513

**Dimensions :**

(Unit : mm)

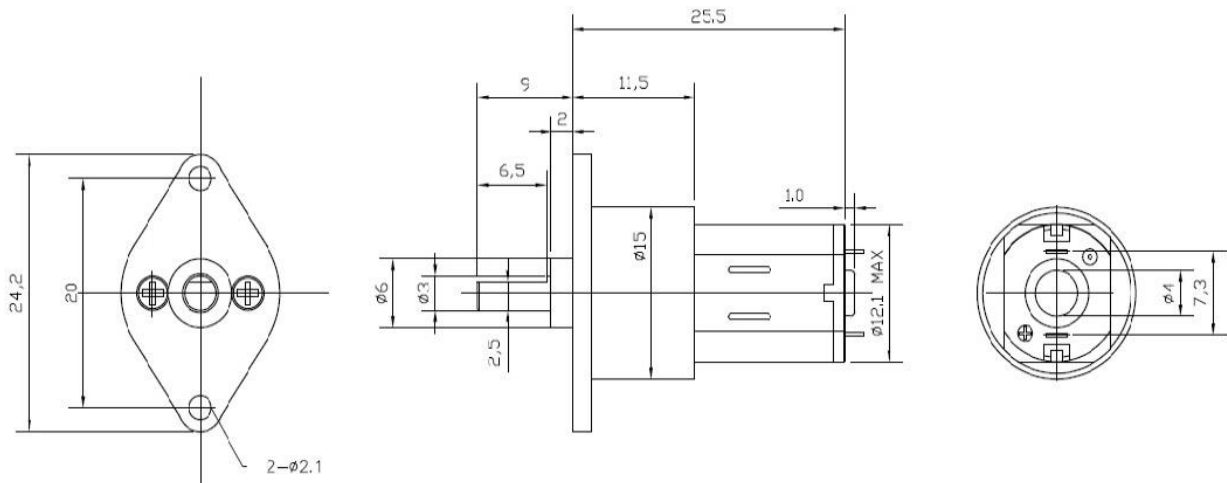

**Curve Drawings :**

